



SAMBHAV GROUP™

# DEEP HILCREST

1RK, 1 RK + TERRACE, 1 BHK & SHOPS

Your  
Dream now  
A  
Reality

KARANJADE, PANVEL.

RERA NO- P52000023307

# GROUND FLOOR PLAN

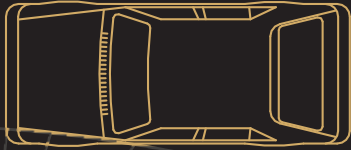
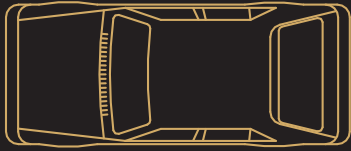
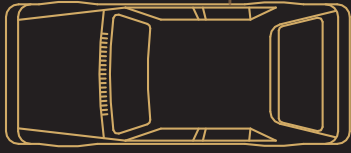
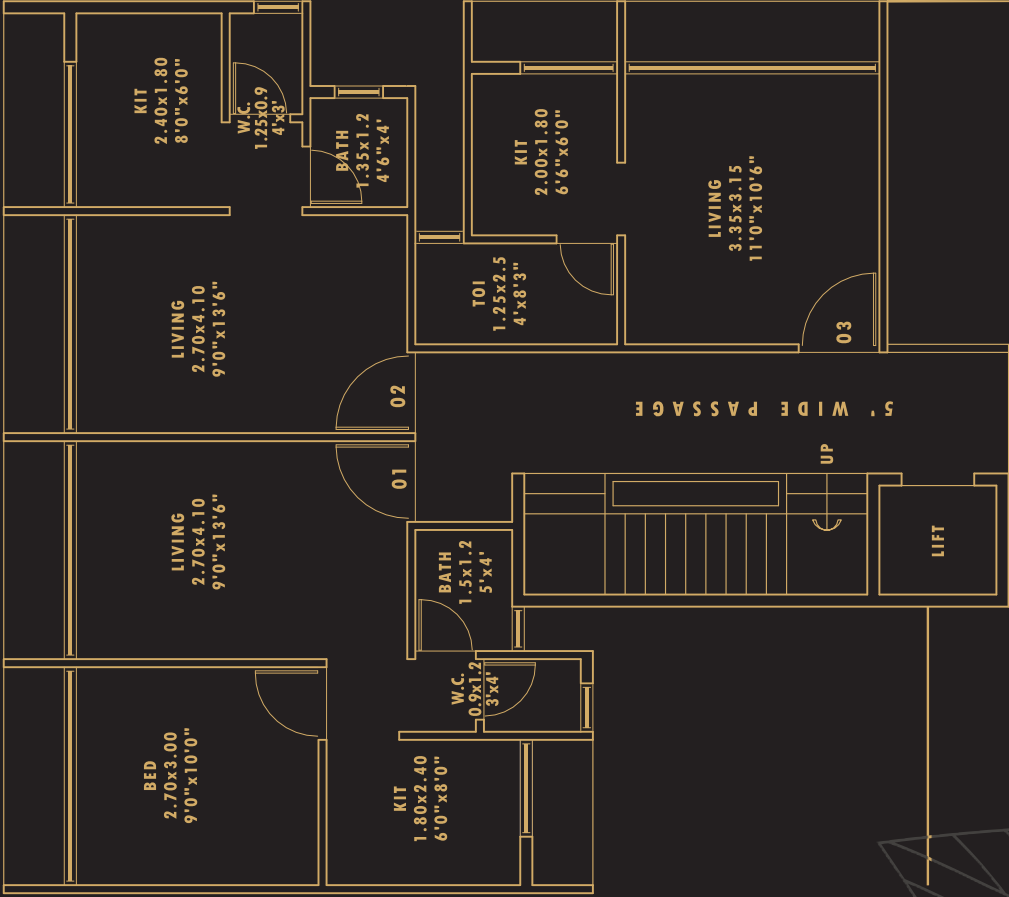

ENTRANCE /EXIT SLIDING GATE

9M WIDE ROAD

# 1ST & 3RD FLOOR PLAN

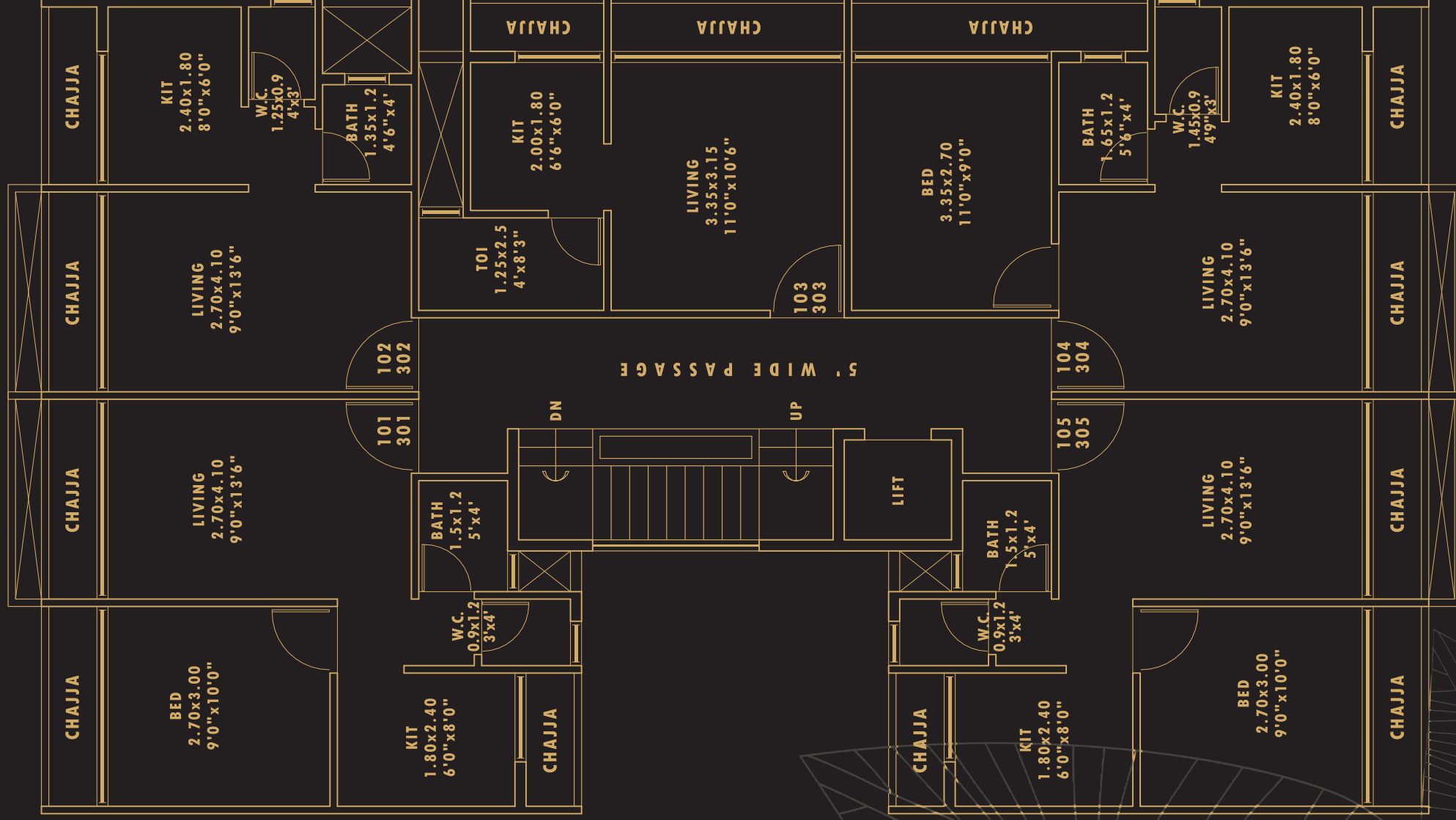

9 M WIDE ROAD



## 2ND FLOOR PLAN

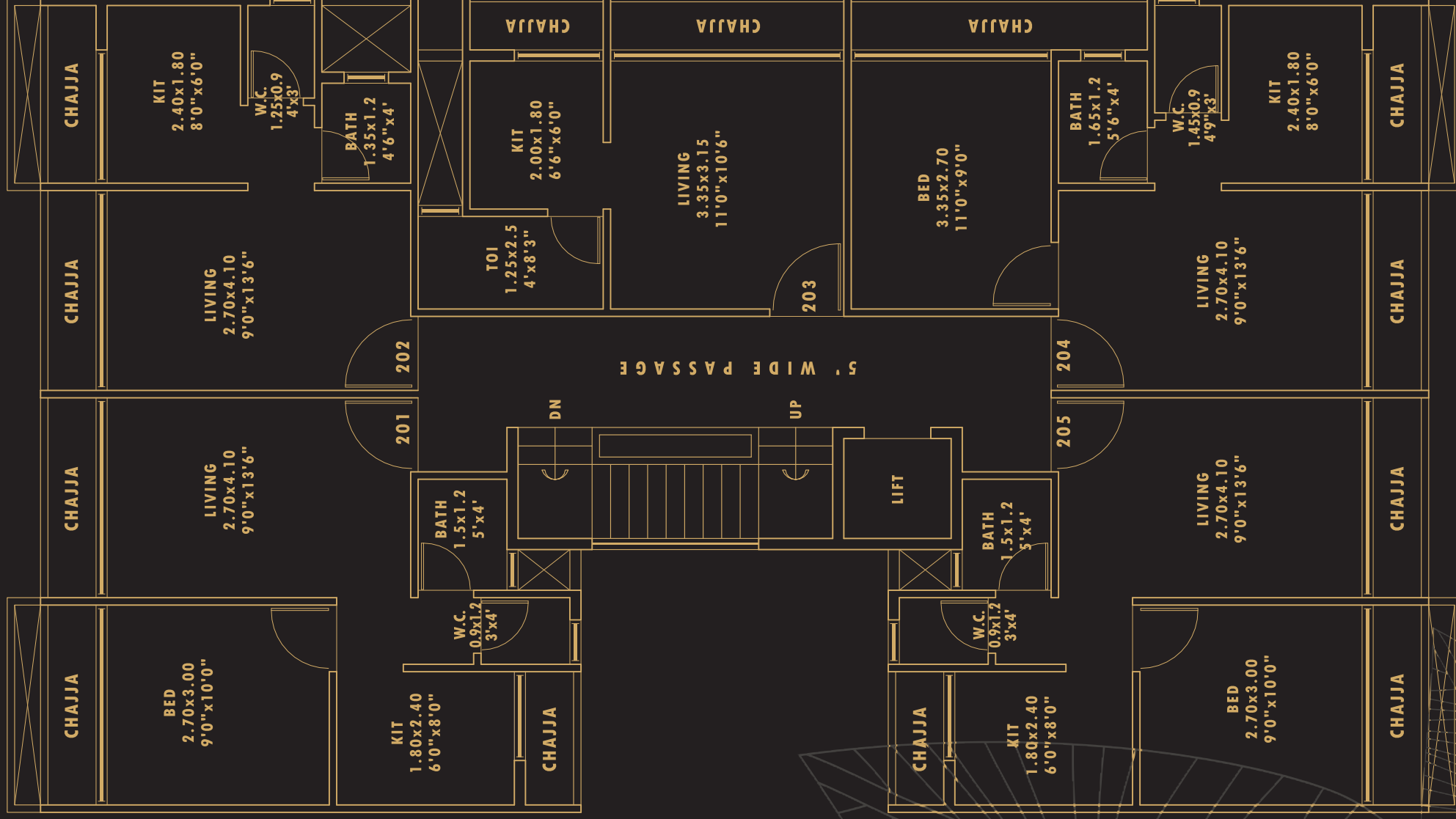

9 M WIDE ROAD

# 4TH FLOOR PLAN

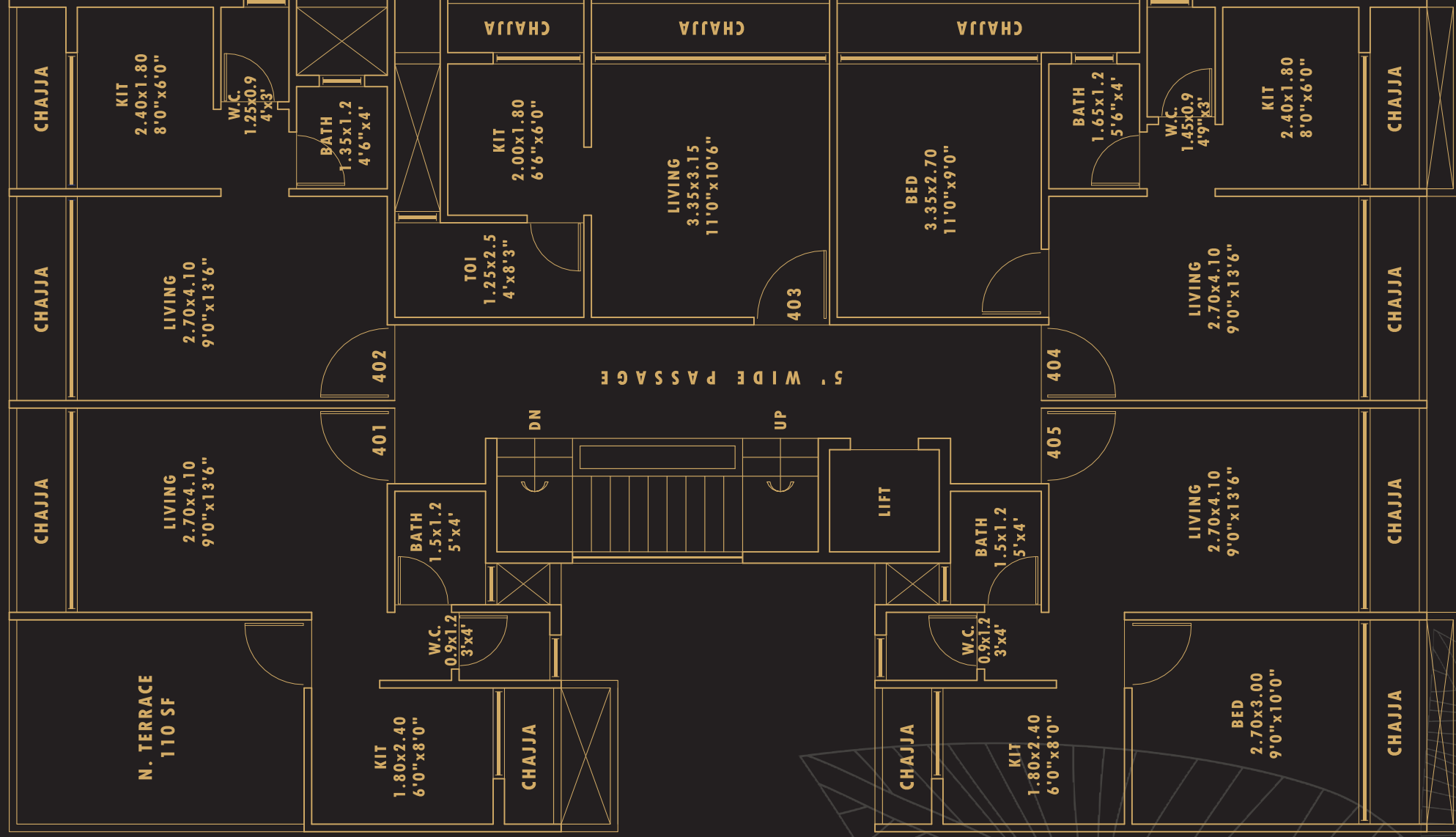

9M WIDE ROAD









# DEEP HILCREST

## FEATURES

- Cidco Allocated Plot
- G + 4 Storied Building
- Spacious 1 RK, 1 RK + Terrace, 1 BHK & Shops Available
- Terrace Flats Available
- Ample Car Parking Space On Ground Floor

## THE PERFECT LOCATION FOR YOUR DREAM HOME".

### CLOSE PROXIMITY

-  Panvel Railway Station
-  ST Depot
-  Sewri – Nhava Sheva Sea Link
-  Jnpt Port
-  Education Institute
-  International Airport
-  Market
-  Hospitals
-  Malls

## AMENITIES



Earthquake Resistant RCC design construction with attractive elevation.



2X2 Vitrified tiles flooring in entire flat.



Granite Platform With Stainless Steel Sinks And Ceramic Tiles Dado Above Counter Upto slab level.



All bathrooms beautifully designed with premium quality tiles.



Good Quality Toilets with Marble Window Sill And Door Frame. Tiles Dado Upto slab level.



Sufficient Electric Points with ISI Marked Switch in all Room.



Concealed plumbing and wiring.



Birla / JK based putty finished wall.



High speed elevators.



Heavy Section powder coated Aluminum windows with good quality glass-open able on 1 side.



Wiring of ISI quality & provisions for TV and A.C. points in entire flat.

JNPT/Uran Road

# MULTI MODAL CORRIDOR 139M

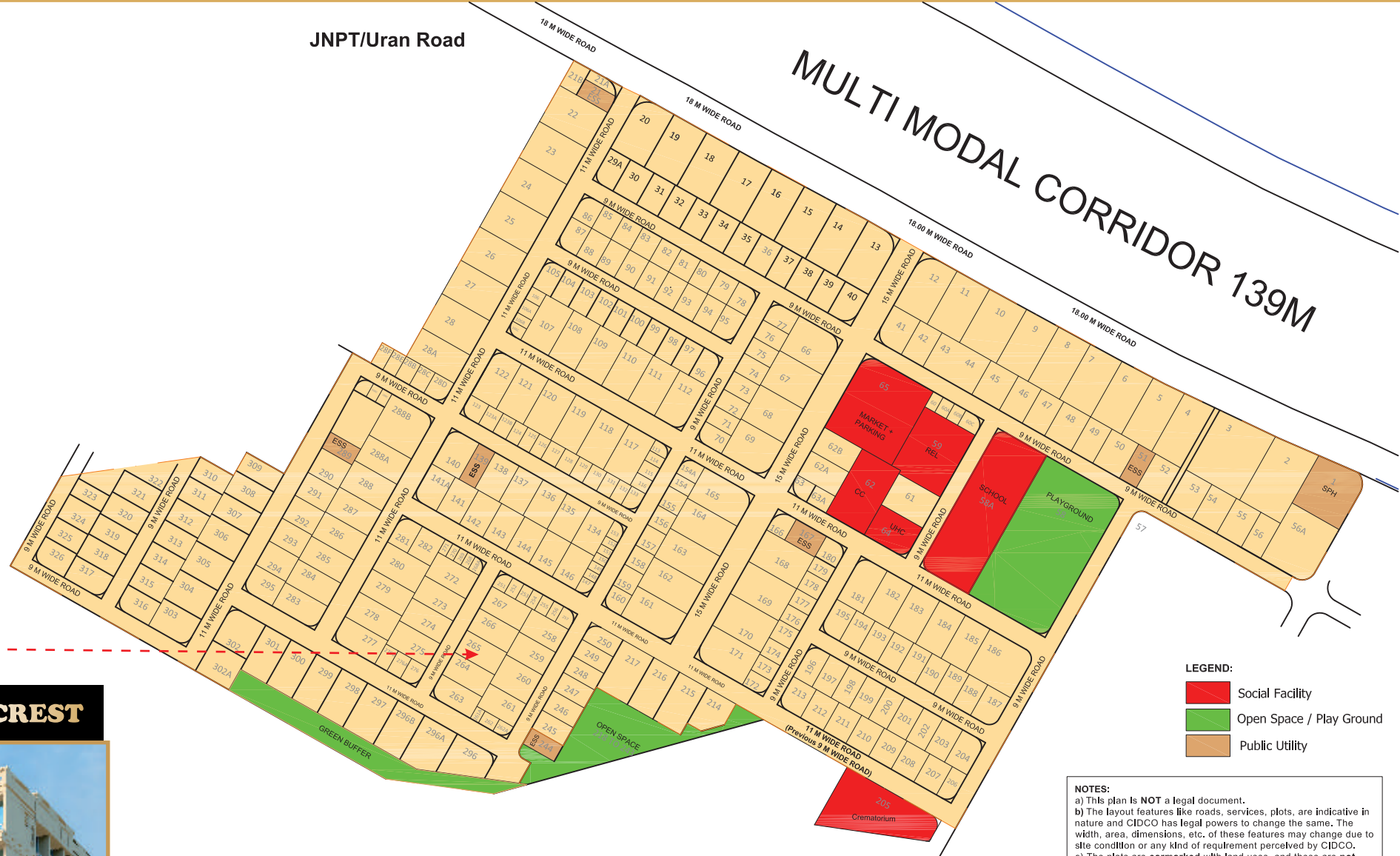





*Live in Peace and Harmony...*

**DEEP HILCREST**

Site Add.: Plot No. 265, Sector - 1, Vadghar, Pushpak Node, Karanjade, Panvel.

Corporate Office : Shop No. 15/16/17/18, Pushpa Ganga CHS.,  
Plot No. 04, Sec. 09, Kamothe, Navi Mumbai - 410 209.

✉ office@sambhavgroup.net ☎ 022 27430 709 🌐 www.sambhavgroup.net