

प्रत्येकाचे स्वप्न  
“संभव” करेल साकार



SAMBHAV GROUP™

# DEEP DIVINE

Plot No. 228, Sector - R4, Pushpak Node, Wadghar, Karanjade, Panvel - 410206

P52000020693

[maharera.mahaonline.gov.in](http://maharera.mahaonline.gov.in)

Images are for representational purposes only.



Images are for representational purposes only.

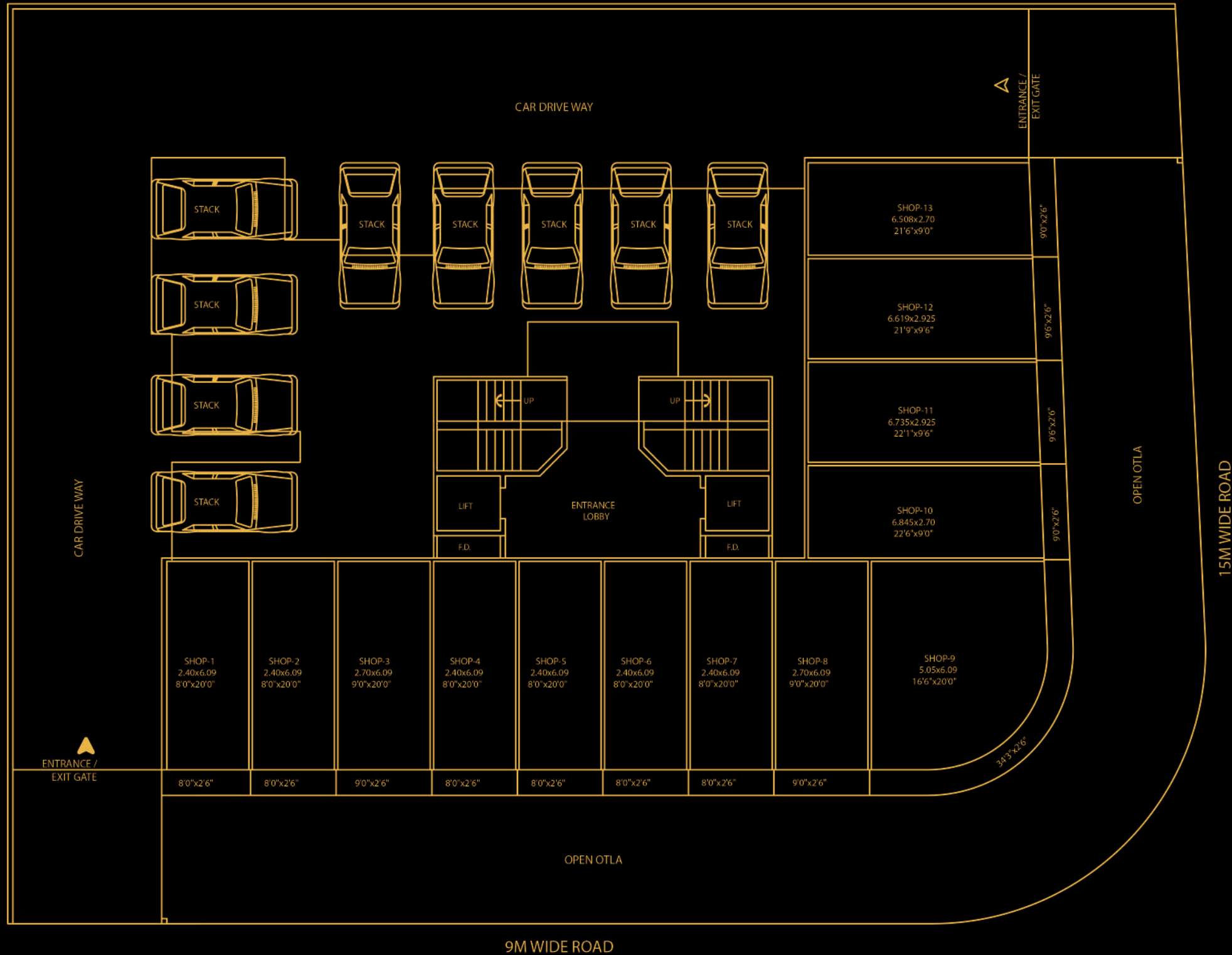

# GROUND FLOOR

Images are for representational purposes only.

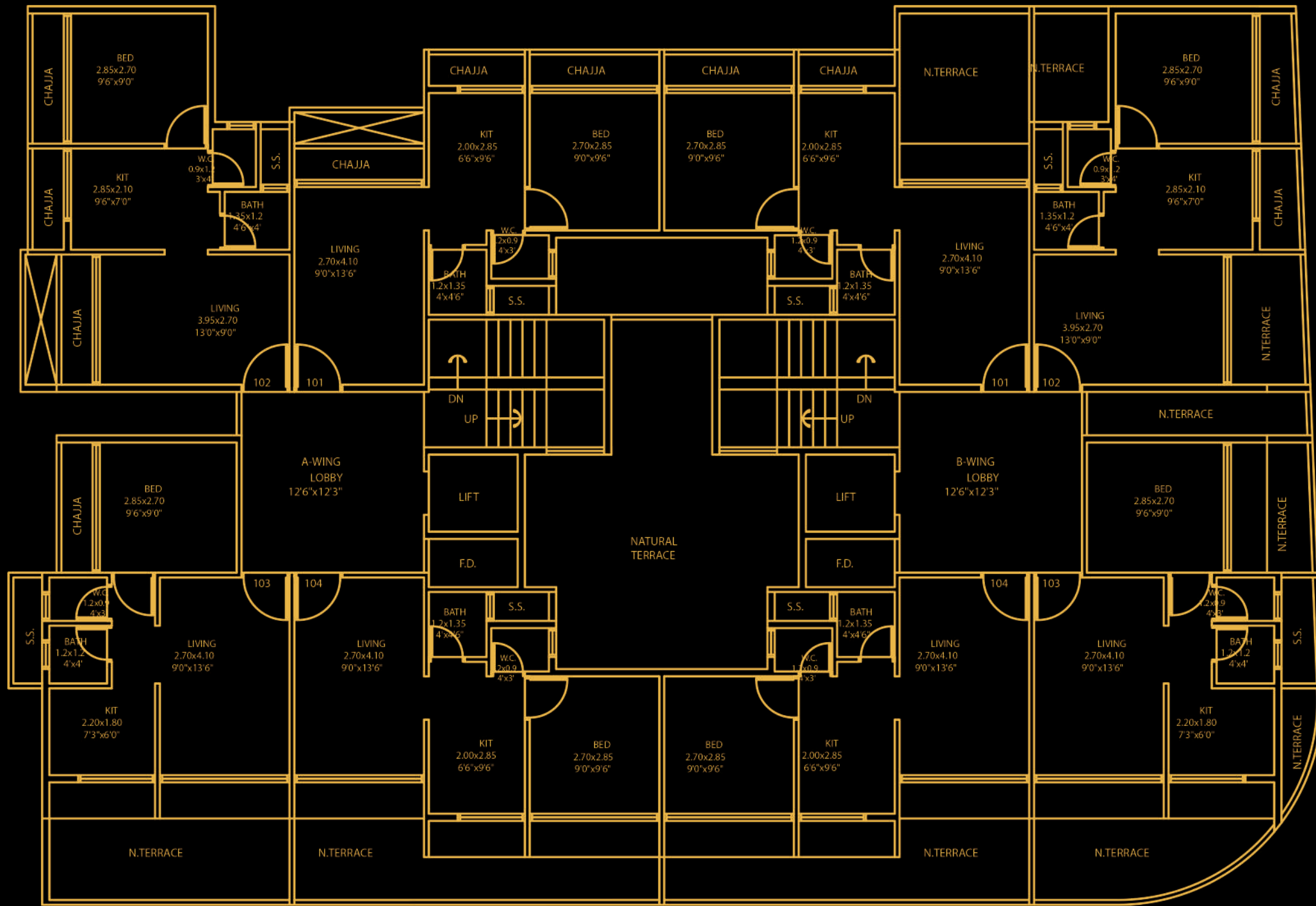

15M WIDE ROAD

9M WIDE ROAD

# 1ST FLOOR

Images are for representational purposes only.

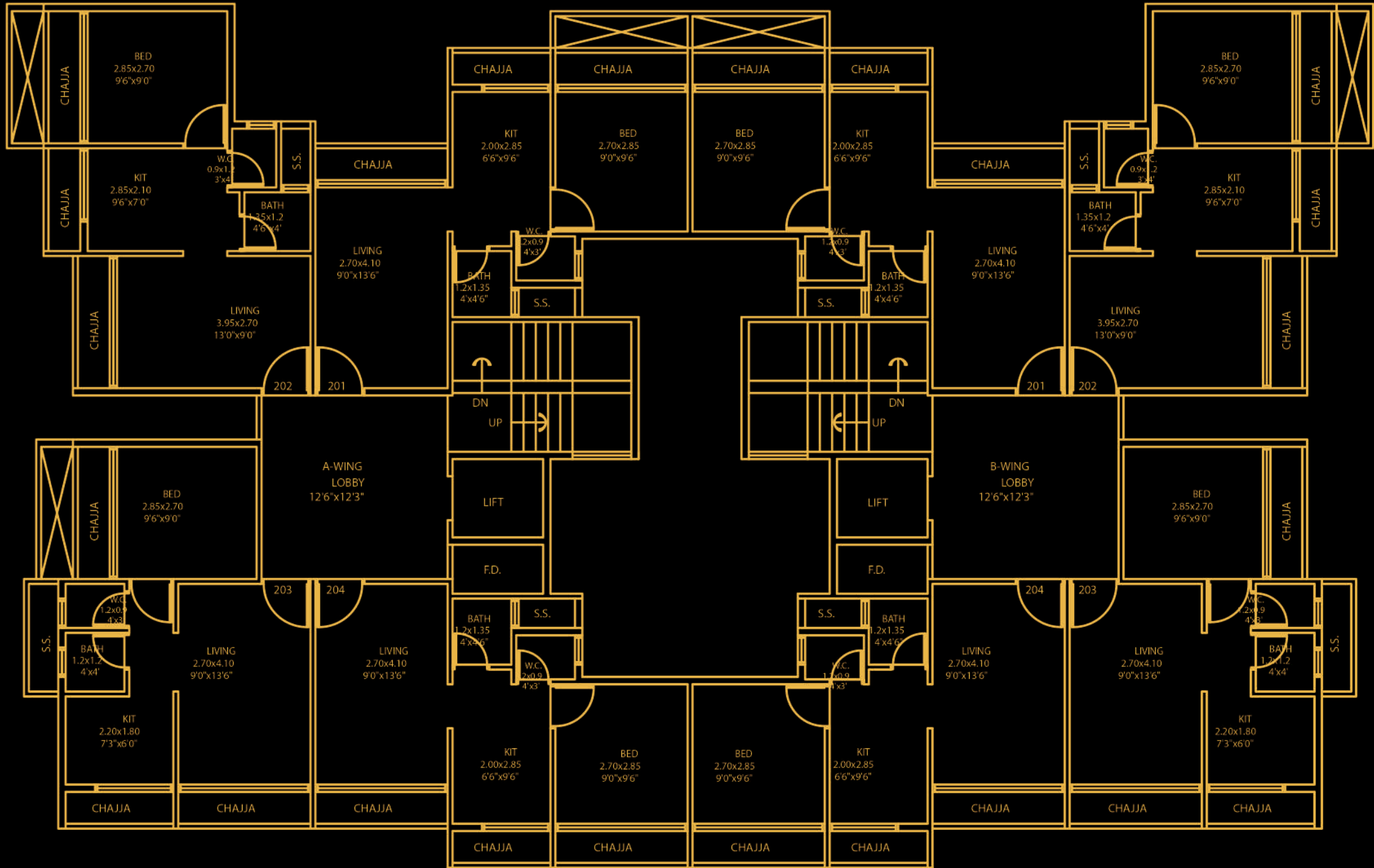

9M WIDE ROAD

## 2ND FLOOR

Images are for representational purposes only.

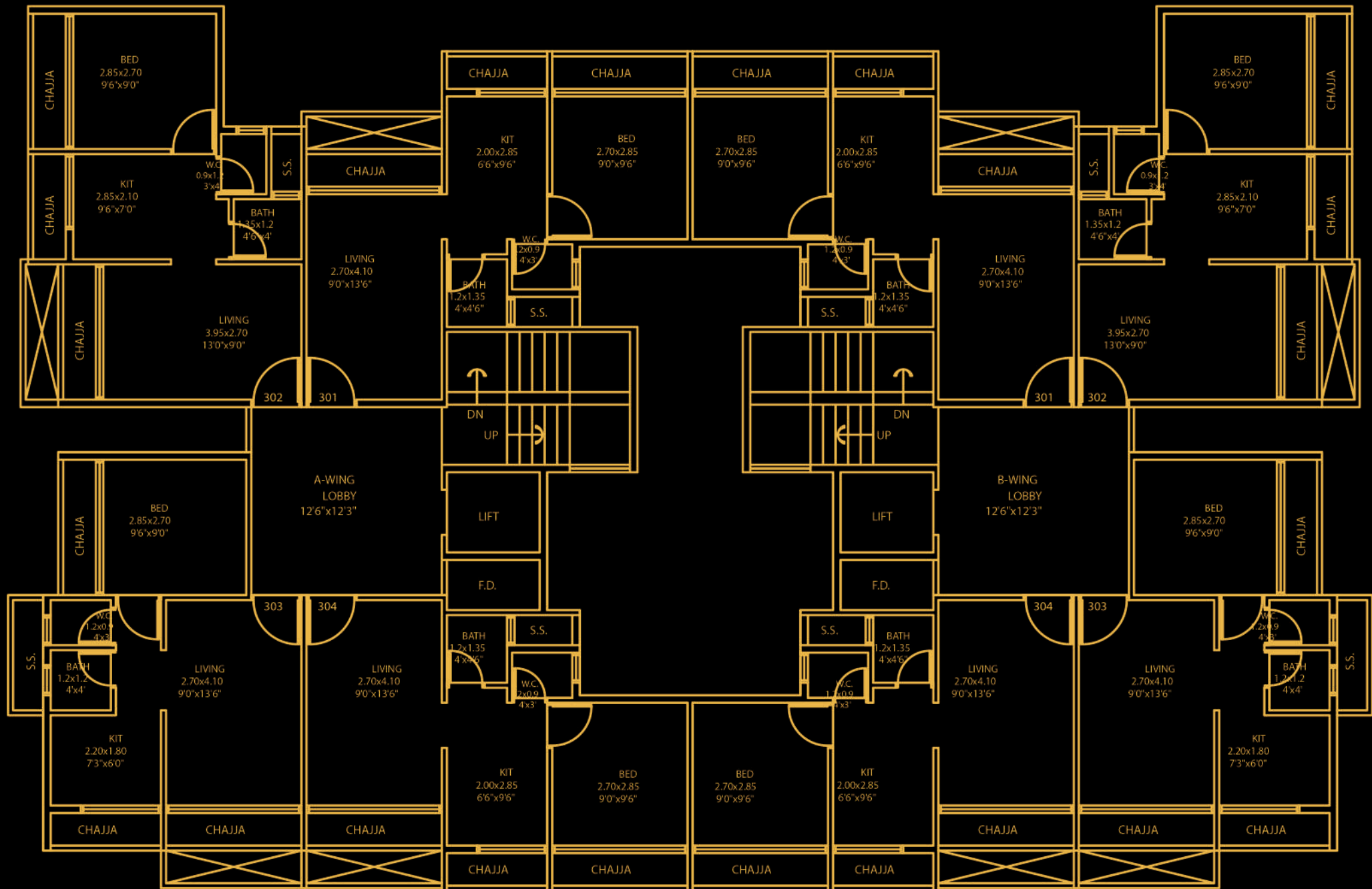

9M WIDE ROAD

15M WIDE ROAD

### 3RD FLOOR

Images are for representational purposes only.

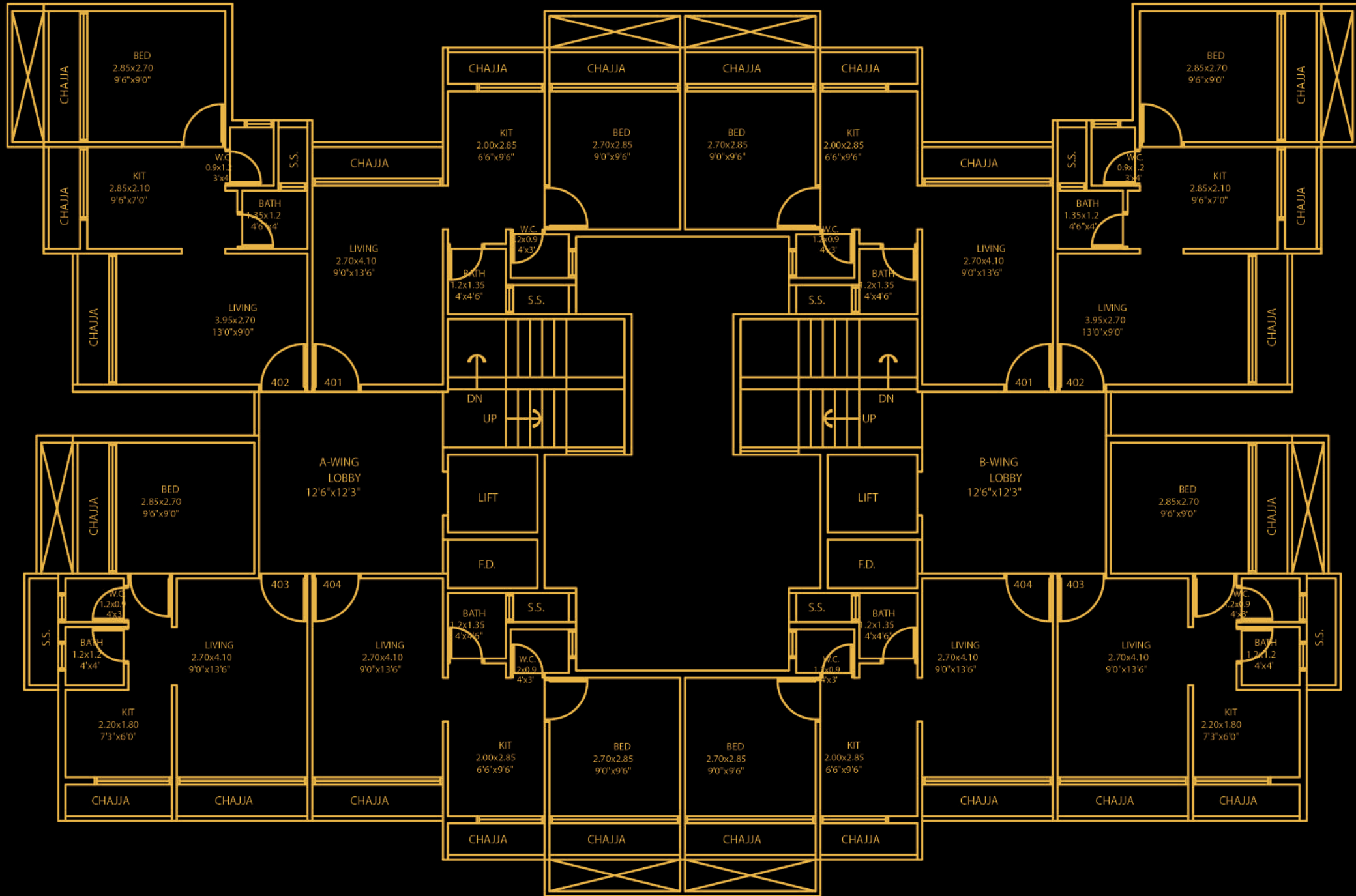

15M WIDE ROAD

9M WIDE ROAD

# 4TH FLOOR

Images are for representational purposes only.

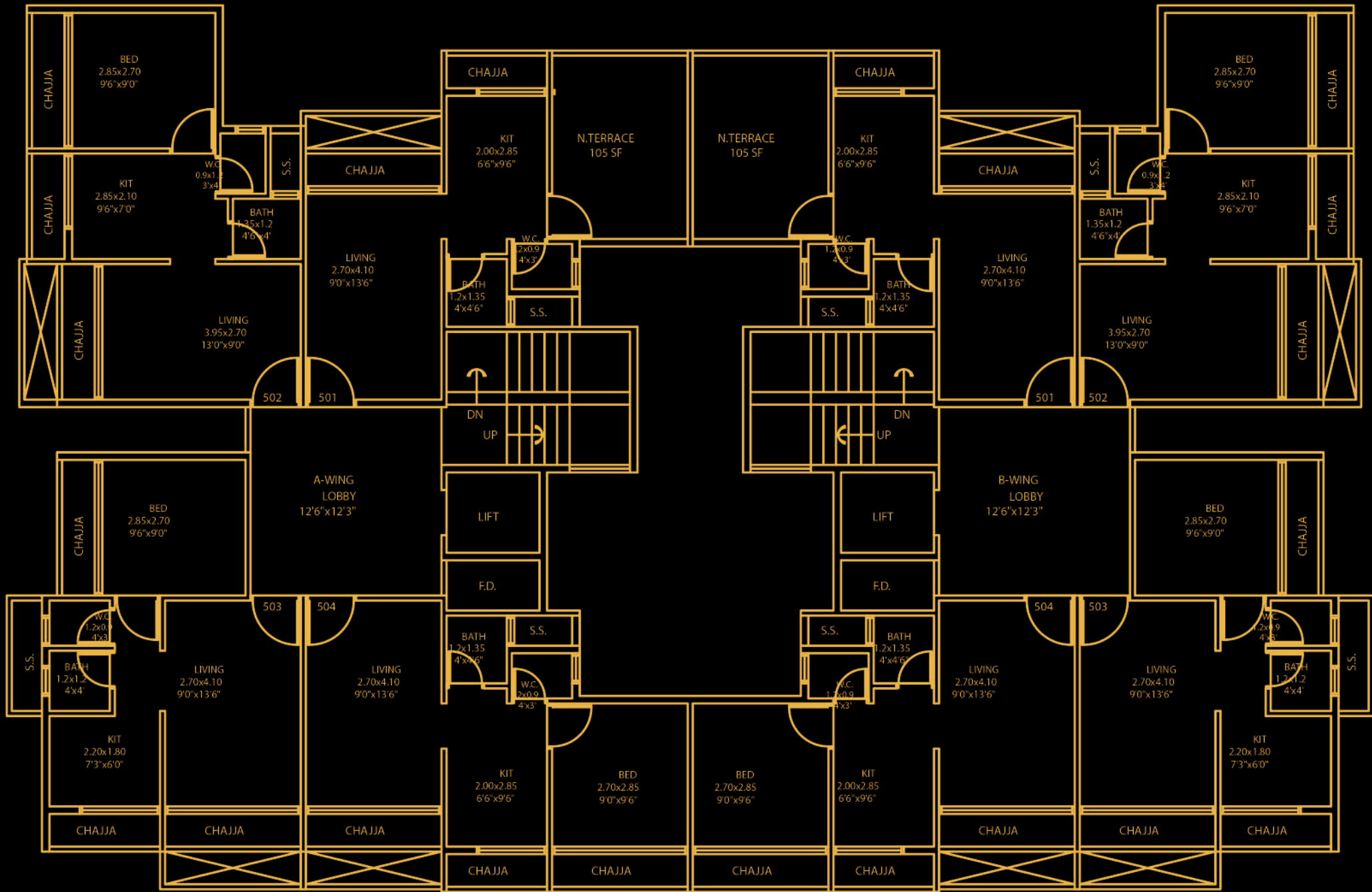

9M WIDE ROAD

5TH FLOOR

15M WIDE ROAD

4TH FLOOR



Images are for representational purposes only.

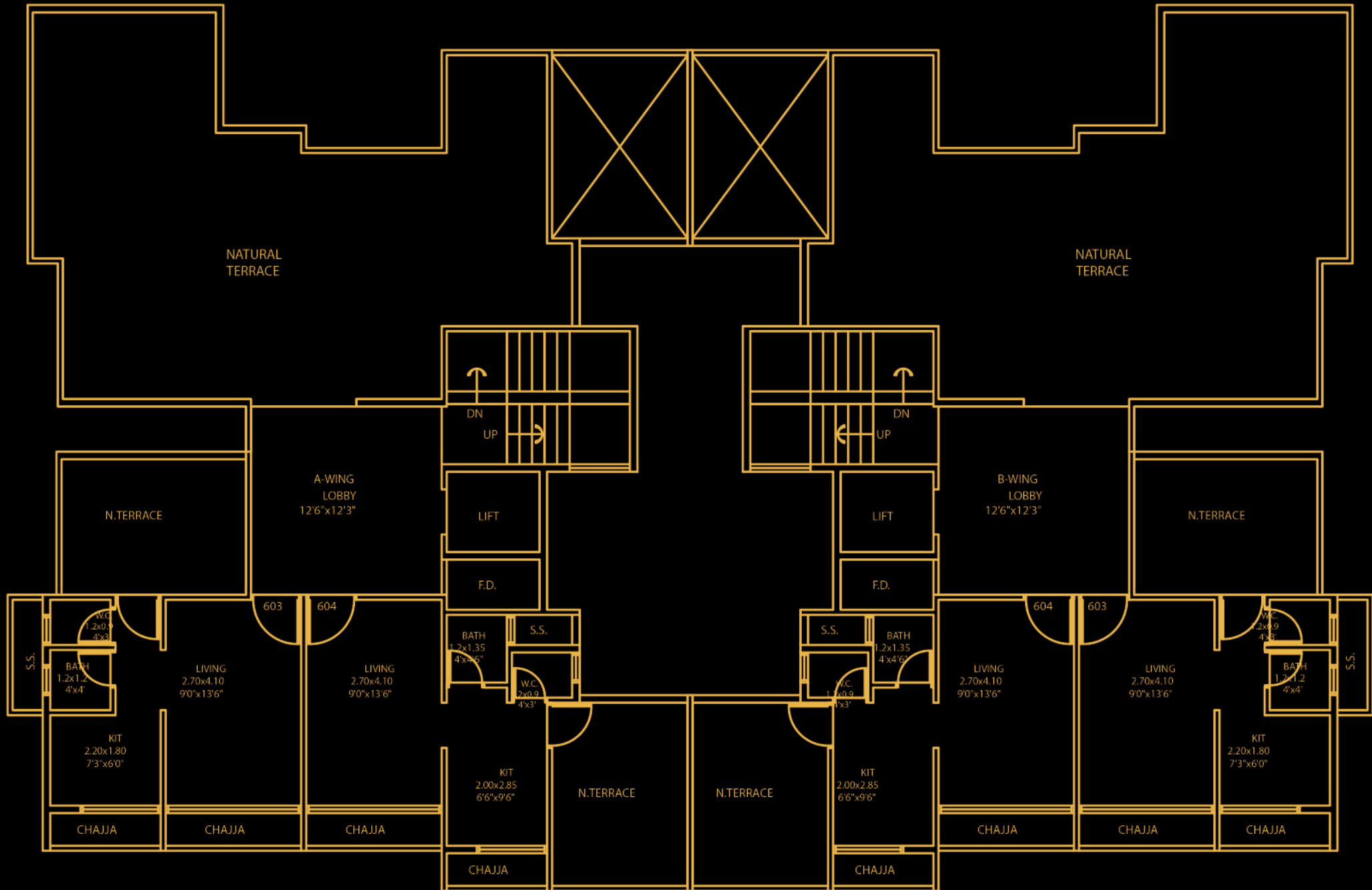

15M WIDE ROAD

4TH FLOOR

9M WIDE ROAD

6TH FLOOR

## Project Features:

- CIDCO Allotted plot
- Ground + 6
- Residential building
- 1BHK, 1RK, 1RK+Terrace, Shops
- Terrace Flat available
- Lifts of reputed make
- Car Parking space on Ground floor

## Location Features:

- Pollution free environment
- Near proposed international Airport
- 10 minutes drive from Panvel Railway Station
- 5 minutes drive from S. T. Depot
- Walking distance from Karnala Sports Academy and surrounded by schools, colleges, hospitals, restaurants etc.
- Karanjade is well connected by Roads and Railways
- ICAO (The International Civil Aviation Organization) Given Techno-feasibility clearance for The International Airport
- The Sewri-Nhava sheva sea link will connect Panvel to Mumbai city in 30 minutes
- Project behind Kalpataru Riverside and opp. to Panchmukhi Hanuman Mandir
- J.N.P.T. Port near by

## Amenities:

### Flooring

- 2' X 2' vitrified tiles flooring in entire Flat.

### Door

- Designer Main Door with elegant fittings.
- Laminate flush door for bedroom.
- Bakelite doors for all bath & W.C.

### Kitchen

- Granite Platform with stainless steel sink and ceramic tiles dado above counter upto 7' height.

### Walls/Paint

- Wall putty finished walls with acrylic distemper paint in entire flat.
- Acrylic paint on external walls.

### Windows

- Powder coated aluminum sliding window with marble sill.

### Electrification

- Sufficient electric points with ISI marked switch in all rooms.
- Provision for cable T.V/Telephone connection in living room & master bedroom.
- ISI marked concealed copper wiring with MCB/ELCB.

### Toilets

- Good Quality toilets with marble window sill and door frame.
- Tiles dado upto 7' height.
- Concealed plumbing.
- Quality CP & Sanitary fittings of reputed make.

### Water

- Underground and overhead water tank with adequate storage capacity.

### Terrace

- Special water proofing treatment with china chips flooring.

### Lift

- Adimaya elevators made lift will be provided.

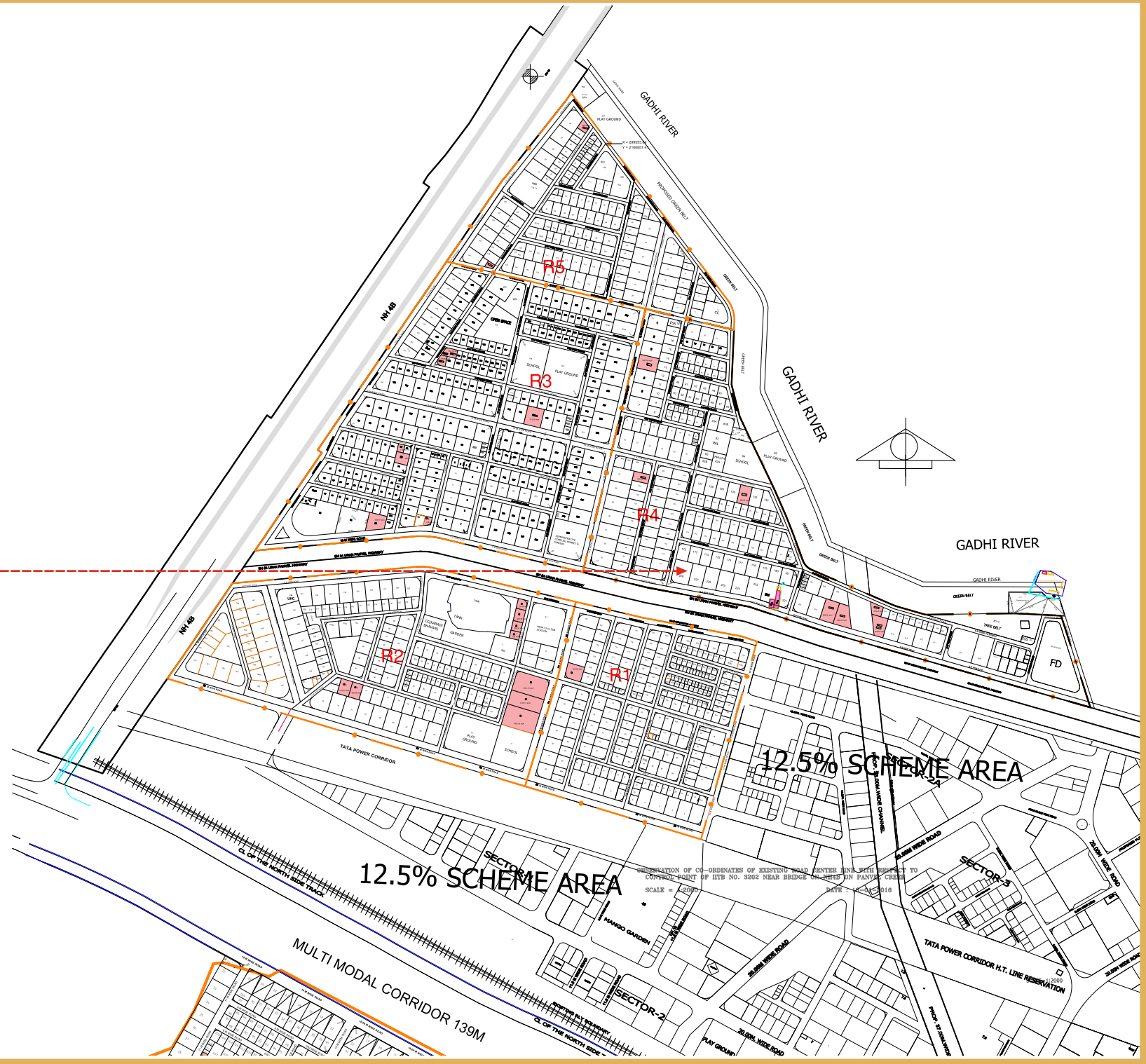

**DEEP DIVINE**



**Plot No. 228, Sector - R4, Pushpak Node, Wadghar, Karanjade, Panvel - 410206**

Disclaimer: Elevations and drawings are subject to approval of authority. The discretion remains with the developers.

नव्या जीवनशैलीसाठी नवी सुरवात

**DEEP DIVINE**

Plot No. 228, Sector - R4, Pushpak Node, Wadghar, Karanjade, Panvel - 410206  
P52000020693  
maharera.mahaonline.gov.in

Shop No. - 15/16, Pushpa Ganga CHS,  
Plot No - 04, Sector - 09, Kamothe, Navi Mumbai - 410 209  
022 27430709  
office@sambhavgroup.net  
www.sambhavgroup.net